

AJP-1410

 OWNER'S OPERATING MANUAL

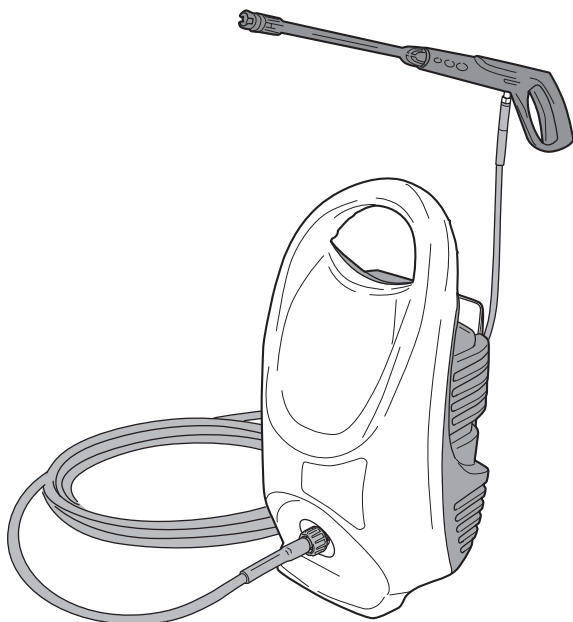

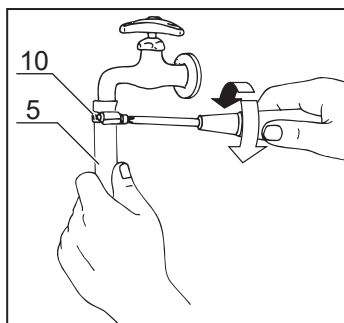

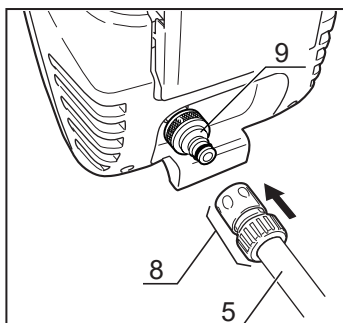
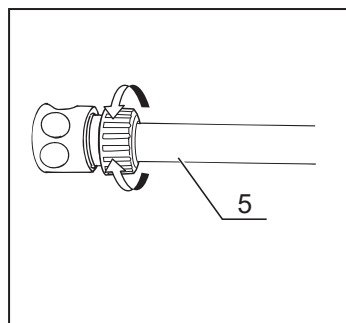
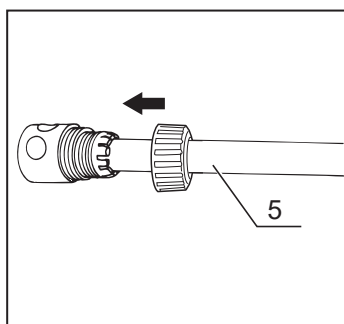
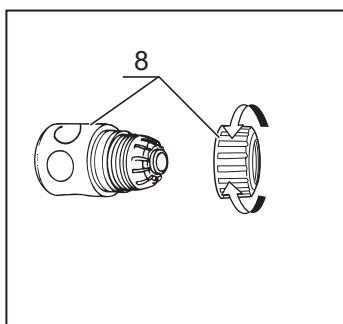
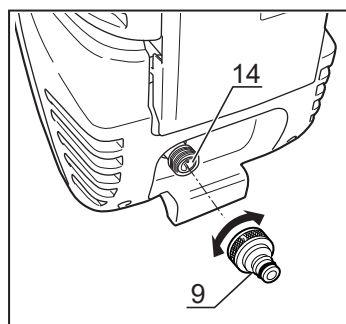
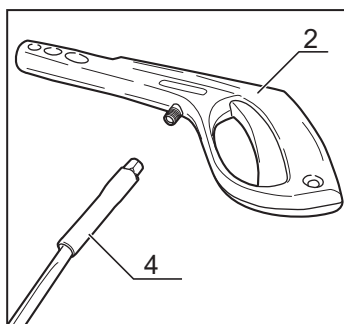
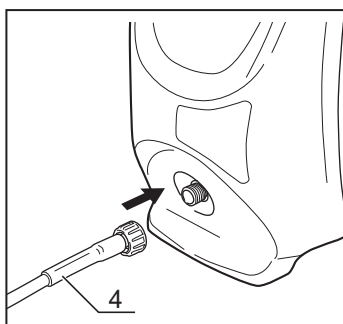
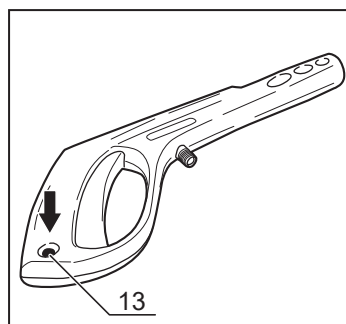
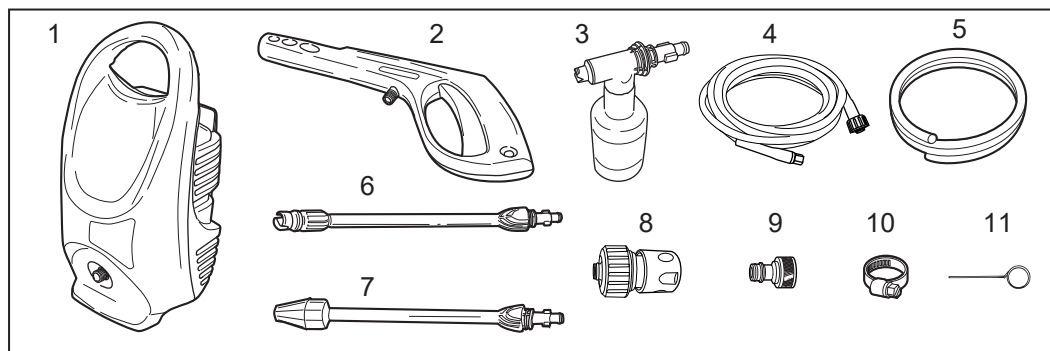
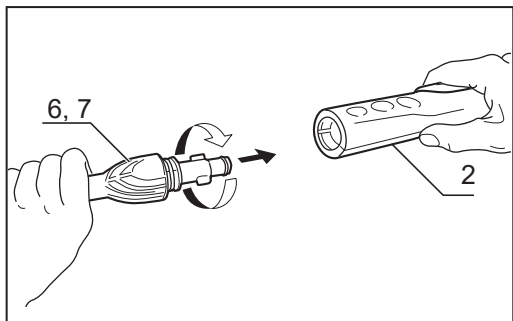

10

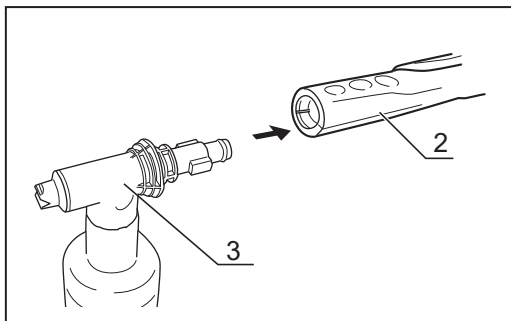

11

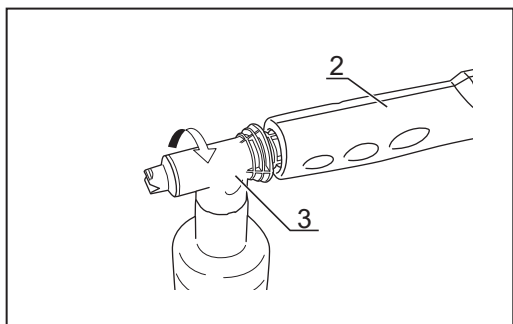

12

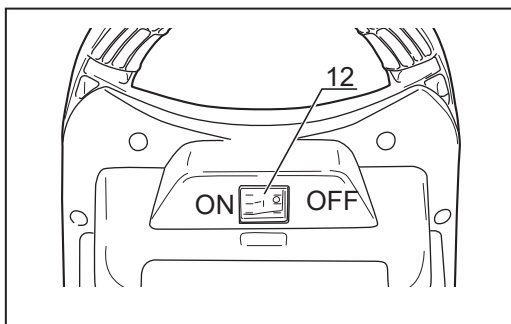

13

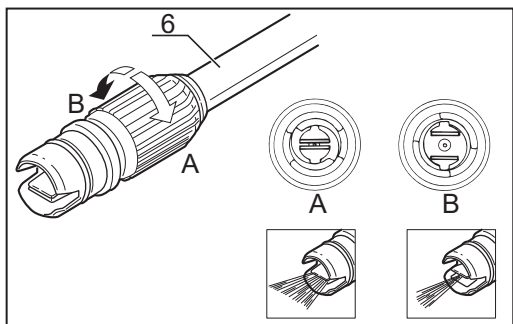

14

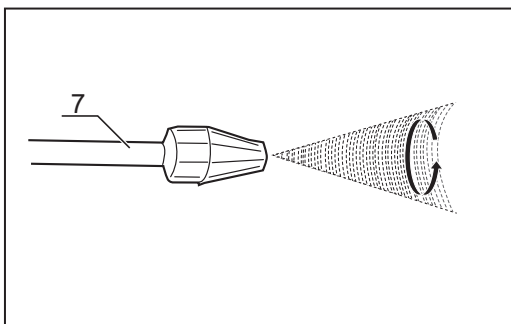

15

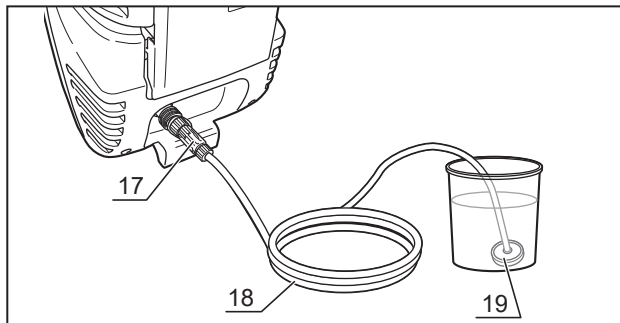

16

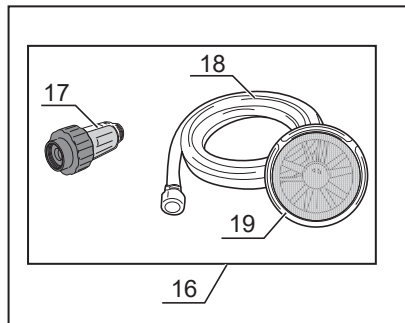

17

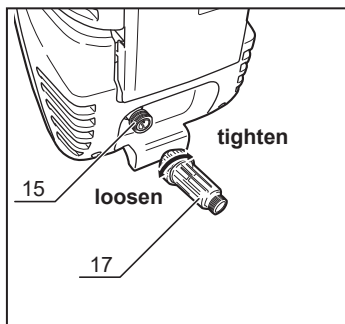

18

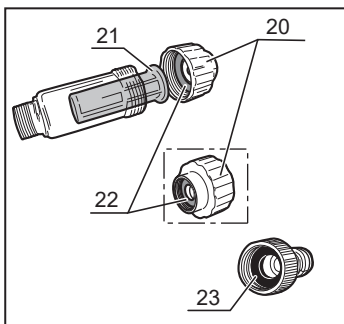

19

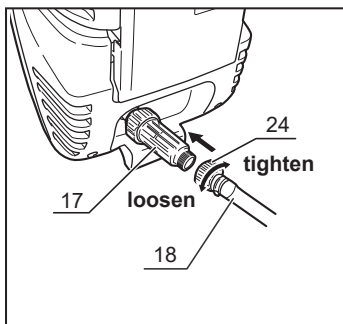

20

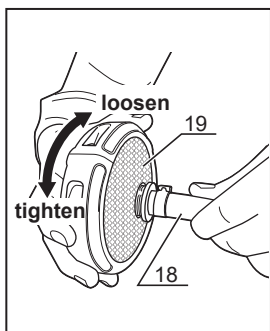

21

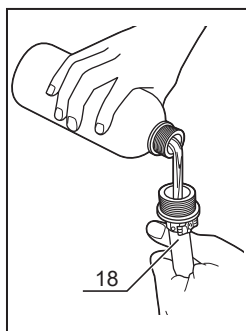

22

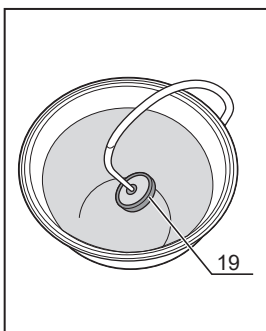

23

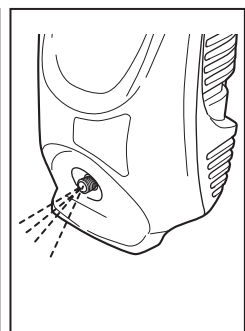

24

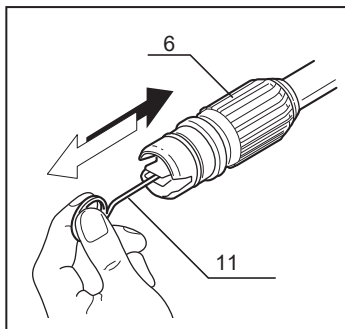

25

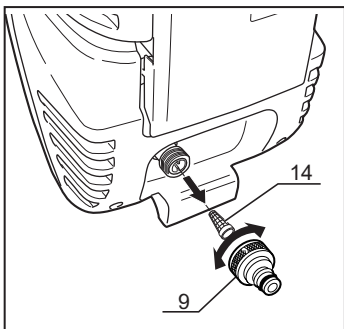

26

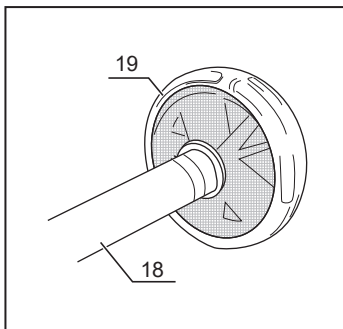

27

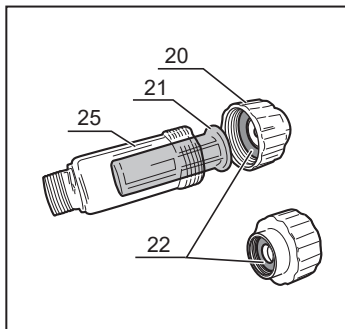

28

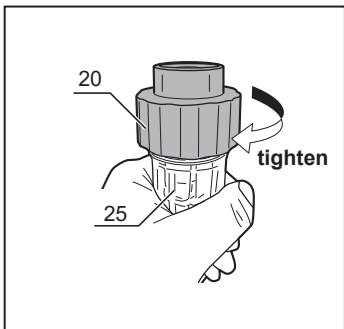

29

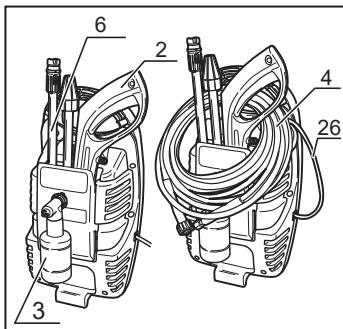

30

Carefully read and understand these instructions before operating this high pressure washer.

Technical data

Power rating input :	1400 W
Rated pressure :	8.5 MPa
Allowable pressure :	12 MPa
Rated flow :	6.0 L / min
Max. water inlet pressure :	0.7 MPa
Rated temperature :	0 - 60°C
Adding water :	From a faucet
Weight :	6.2 Kg

Name of Parts:

- | | |
|---------------------------|----------------------------------|
| 1. Main unit | 16. Self-priming kit (option) |
| 2. Spray gun | 17. Self-priming filter (option) |
| 3. Detergent nozzle | 18. Self-priming hose (option) |
| 4. Spray gun hose (6m) | 19. Strainer (option) |
| 5. Water supply hose (3m) | 20. Filter cap (option) |
| 6. Variable nozzle lance | 21. Filter (option) |
| 7. Turbo nozzle lance | 22. Rubber seal (option) |
| 8. Hose joint | 23. Rubber seal (option) |
| 9. Water connector | 24. Ring (option) |
| 10. Hose clamp | 25. Filter case (option) |
| 11. Nozzle cleaning pin | 26. Power cord |
| 12. Switch | |
| 13. Safety lock button | |
| 14. Filter | |
| 15. Water inlet | |

Preparation

Before starting up your machine, we advise you to carefully read through this instruction manual. Follow all instructions to minimize the risk of injuries when using the machine.

Prior to operation

Before starting up your machine, please check it carefully for any defects. If you find any, do not start up your machine and contact your distributor.

Especially check:

The insulation of the electric cable should be faultless and without any cracks. If the electric cable is damaged, it should be replaced by our authorized distributor.



Mains power supply connection

The following should be observed when connecting the machine to the electric installation:

- Check before operation that the local power supply is the same as the specifications on the rating label.
- This machine is equipped with universal motor with double insulation. It is not necessary to have earth connection.
- The electric installation shall be made by a certified electrician.
- It is strongly recommended that the power supply to the machine should include a residual current device (GFCI).
- Product protection degree: IPX5

General safety regulations and accident prevention

It is essential that you read the safety regulations and operating instructions in their entirety and follow the information contained therein in order to eliminate the possibility of an accident or potentially dangerous situation from occurring while working with the machine.

- The power plug must be plugged into a properly installed socket. The power supply should include a residual current device for max. 30 mA.
- Always check the device, the mains cable and the plug before using the machine. Only operate the device when it is in good working order and has not been damaged in any way. Damaged parts must be immediately replaced by a qualified electrician.
- Always pull the power plug out of the socket outlet before doing any work on the machine, before changing the nozzle and whenever it is not being used.
- **Warning!** Unsuitable extension cable can be dangerous.
- If an extension cable is used, the plug and socket must be of watertight construction.
- Only use suitable extension cable when working outdoors. Extension cable must have a minimum cross-section of 1.5 mm².
- **Warning!** This device was developed to be used with cleaning agents supplied or recommended by the manufacturer. The use of any other cleaning agents or chemicals can negatively affect the safety of the device.
- Cable connections should be kept dry and off the ground. Always uncoil the extension cable completely to avoid heat damage to the cable.
- **Warning!** Do not use the device when other persons or animals are in the near vicinity unless they are wearing appropriate protective clothing.
- **Warning!** High pressure jets can be dangerous when the machine is not use properly. Do not direct the jet toward persons, animals, live electrical equipment or the device itself.
- Do not direct the jet against yourself or others in order to clean clothes and footwear.
- Children should be supervised to ensure that they do not play with the appliance.
- This appliance is not intended for use by persons (including children) with reduced physical, sensory or mental capabilities, or lack of experience and knowledge, unless they have been given supervision or instruction concerning use of the appliance by a person responsible for their safety.
- **Warning!** Spray gun hoses, fittings and couplings are important components for the safety of the device. Only use spray gun hoses, fittings and couplings that are recommended by the manufacturer.
- In order to ensure the operational safety of the device, only use genuine manufacturer's replacement parts or parts that have been approved by the manufacturer.
- Do not operate the device if the mains cable or other important parts of device – e.g. safety related elements, spray gun hose, spray gun – are damaged.
- Do not pull or carry the electric tool by its mains cable. Protect the mains cable from becoming damaged by oil, solvents and sharp edges.
- Keep your place of work tidy.
- Ensure that the switch is turned off when connecting the machine to the power supply.
- Wear the suitable work clothes.

- Check your machine to ensure that it is in good working order. If it is not functioning properly, have it checked by our authorized distributor. Have all maintenance and inspection work carried out only by our authorized distributor.
- The water jet that emerges from the high pressure nozzle produces a 'kickback' on the spray gun. Therefore, make sure that you have a solid footing and that you have a firm hold of the handle grip. In order to protect yourself from possible flying objects (that are released due to the high pressure).
- The high pressure jet can damage vehicle tyres and tyre parts. Keep a distance of at least 30 cm from the object being cleaned.
- If there is a power failure while you are using the machine, be sure to switch off the machine for safety reasons.
- The electric pump always must be able to draw on a sufficient supply of water. Dry operation causes severe damage to the seals.
- Disconnect from the power supply before carrying out user maintenance.
- Only use genuine spare parts from the manufacturer or approved by the manufacturer.
- If the supply cord is damaged, it must be replaced by our authorized distributor in order to avoid a hazard.
- Never use the machine in an environment where there could be a danger of explosion. If any doubt arises, please contact our authorized distributor.
- It is not allowed to clean asbestos-containing surfaces with high pressure.
- This machine must not be used at temperatures below 0°C.
- The electric supply connection (for example, connection the RCD or fix wiring) shall be made by a qualified electrician and comply with IEC60364-1: Low-voltage electrical installations.

Safety devices

Safety lock on spray gun (Fig.1)

The spray gun features safety lock button (13). When the lock is activated, the spray gun cannot be operated.

Motor pump protection

The motor is equipped with a motor circuit breaker switch. When the motor starts to run hot, it is cut out automatically by this switch. Switch off the machine. Wait 5 ~ 10 minutes before using the device again. Try to determine the cause of the fault. If the problem repeats itself, please contact our service centre.

Using cleaning agent

Fill detergent tank with an appropriate cleaning agent, and the connect the detergent nozzle to the spray gun.

Operating instructions

Purpose

The machine is designed to clean vehicles, machines, buildings, facades, etc. in the private sector.

Areas of application

- Never use the machine in potentially explosive areas under any circumstances!
- The operating temperature must be between 0°C and +60°C.
- The machine consists of an assembly with a pump, which is encased in a shock absorbing housing. For an optimal working position the machine comes with a lance and a non-slip handle grip, whose shape and configuration comply with the applicable regulations.
- Do not cover or modify the lance or the spray nozzles in any way.
- The machine is designed to be used with cold or lukewarm (max. 60°C); higher temperatures can damage the pump.
- Do not use water that is dirty, gritty or contains any chemical products, as these could impair operation and shorten the life of the machine.

Connection

1. Screw the spray gun hose (4) onto the water outlet pipe and the spray gun (2) by turning it clockwise. (Fig.2, 3)
Prior to operating the machine, please ensure that the spray gun hose has been completely uncoiled.
Whilst the machine is in operation, the hose **MUST NOT** loop.
2. Check that the filter(14) is mounted in the water inlet and that it is not blocked up.(Fig.4)
3. The inlet filter must always be fitted in the water inlet to filter out sand, limestone and other impurities, as they will damage the pump valves.
CAUTION: Failure to fit the filter will invalidate the guarantee.
4. Screw the water connector(9) onto the water inlet. (Fig.4)
5. Connect the water supply hose (5) (min. hose diameter 13mm) to the water tap and machine. Ask your local plumber about this.(Fig.5 - 9)
6. Insert the lance (6, 7) into the spray gun (2) and turn it to lock it. (Fig.10)
Make sure that the spray gun is locked in the OFF position by pulling out the locking button and locating it on the tab in the handle grip.
7. Mount the nozzle or any other equipment you want to use. (Fig.11,12)
8. Connect the machine to power supplies.

Starting up

1. Open the water inlet. Press the safety lock button(13) on the spray gun and pull back the trigger lever in order to bleed the trapped air out of the device.
2. Turn on the switch on the device. (Fig.13)
3. To temporarily turn off, release the trigger lever, at which point the device goes to standby. As soon as you press the trigger lever again, the machine restarts.
4. To completely turn off the machine, press the ON/OFF switch on the device.
5. The shape of the water jet can be changed from concentrated to flat jet by turning the nozzle.
Using the lance with rotating nozzle is particularly effective in cases of very stubborn dirt. (Fig.14)

Correctly using the device

1. The machine must be set upright on a level, stable surface.
2. The spray lance is affected by a thrust during operation – therefore, always hold it firmly with both hands.

IMPORTANT: Point the nozzle at the ground.

3. Activate the trigger of the spray gun.
4. Always adjust the distance and thus the pressure of the water to the surface which is to be cleaned.

NOTE: The spray angle can be adjusted at the nozzle.

NOTE: Do not cover the machine during operation. If the machine is left or not used, it must be switched off (ON/OFF switch) on the start.

It is normal for the pump to leak a little; this is necessary to avoid damage to the pump when it is at a standstill.

End of operation

1. Press turn off the ON/OFF switch (12).
2. Disconnect the plug from the socket.
3. Shut off the water supply, detach water supply hose and activate the spray gun to relieve the machine of pressure.

WARNING! Failure to follow the above instructions may cause damage to the machine.

Self-priming kit (optional accessory)

Use with alternative water sources(Fig.16)

By attaching self-priming kit, which is an optional accessory, this machine can draw in water from alternative water sources, such as water butts and water containers.

* Need to prime the hose beforehand to remove the air bubble inside the hose.

* The discharge pressure will be lower compared with when supplying water from a faucet.

NOTE: Make sure to operate this machine on level ground.

Things to prepare

- Self-priming kit (Fig.17)
- Water for priming the hose (approximately 1L)
- Water container
- Water for cleaning

How to use

Warning! Make sure to clean the Self-priming filter, the strainer on Self-priming hose, and filter on the machine, before connecting. It will cause low discharge pressure or malfunction of the machine when using with the dust adhered.

1. Remove spray gun hose from the machine.

- Loosen the ring by turning counter clockwise and remove it.

2. Attach Self-priming filter.(Fig.18)

- * Remove water supply hose(5) and water connector(9) if they are set.
- Attach Self-priming filter(17) into water inlet by turning clockwise.

NOTE:

- Tighten Self-priming filter straight onto the water inlet by turning it in a clockwise direction(If the filter is not tighten correctly onto the inlet, leaking may occur).
- Make sure that the filters on Self-priming filter and machine are correctly set. Operating without the filters cause the malfunction of the machine.
- Rubber seal is set inside of filter caps of the connector and the Self-priming filter. Please be careful not to lose them when removing.(Fig.19)

3. Attach Self-priming hose onto Self-priming filter. (Fig.20)

- Insert Self-priming hose(18) straight into Self-priming filter(17) and securely tighten by turning the ring(24).

NOTE: Pulling the Self-priming hose forcefully left or right may cause water leakage from the connection part.

4. Remove the strainer from Self-priming hose by turning it.(Fig.21)

NOTE: Be careful with the connecting part of strainer as some wire may be come out unexpectedly.

5. Pour water into Self-priming hose from the water supply side.(Fig.22)

- Lift up the self-priming hose higher than the machine, and then pour water (approximately 1L) slowly until the hose is totally filled.
- Set strainer onto Self-priming hose in the reverse order of removing it.

NOTE: Make sure to adjust the screw thread of the strainer and hose before tightening to avoid the breakage of the screw thread.

6. Put the strainer into water container filled with water.(Fig.23)

- Make sure that no air enter inside of Self-priming hose.

7. Check whether the water is supplied.(Fig.24)

- Turn on the machine and check whether the water is supplied or not. If there is no problem, turn it off.

Ready to use.

Connect the spray gun hose and start the operation.

When the machine does not suck up water properly or water leakage is occurred, the following cause may be concerned.

- Self-priming filter is not fully tightened.
- Self-priming filter is not properly attached onto water inlet
- The filter inside of Self-priming filter is not properly set, and there is space between filter and rubber seal.

If the above-problem occurs, remove Self-priming filter and then set it again in the following procedure:

1. Confirm that the filter inside of Self-priming filter is set properly by loosing the filter cap (Fig.A).
2. Hold the filter case vertically and tighten the filter cap securely.
3. Tighten Self-priming filter onto the water inlet of the machine securely.

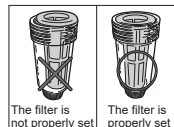

Maintenance and storage

WARNING! Always disconnect the plug from the socket prior to maintenance or cleaning.

To ensure a long and problem free working life, please take the following advice:

- Wash off water hose, spray gun hose, spray lance and accessories before mounting.
- Clean the connectors of dust and sand.
- Rinse the detergent spraying attachment after use.

Any repair should always be made by our authorized distributor with genuine spare parts.

Cleaning of lance nozzle (Fig.25)

A clogging up in the nozzle causes a pump pressure which is too high. This is why cleaning is required immediately.

1. Stop the machine and disconnect the nozzle.
2. Clean the nozzle.

IMPORTANT: The cleaning tool should only be used when the spray lance is detached.

3. Flush the spray lance backwards with water.

The inlet filter must always be fitted inside the water inlet pipe to filter out sand, limestone and other impurities, as they will damage the pump valves.

Checking the water intake filter (Fig.26)

Clean the water inlet filters regularly once a month or more frequently in accordance to use. Periodically check the filter in order to prevent clogging, which could jeopardize operation of the pump. To do this, unscrew the connection coupling for the water inlet hose from the device and clean the exposed inlet sieve by placing it under running water.

CAUTION: Failure to fit the filter will invalidate the guarantee.

Cleaning of strainer (optional accessory) (Fig.27)

- Flush with running water and remove the dust on the mesh.

NOTE: The clogging of the strainer will cause the decrease of the discharge pressure.

Cleaning of Self-priming filter (optional accessory) (Fig.28,29)

1. Remove the filter cap and take out the filter from the filter case.
2. Remove dust on the mesh of filter.
3. Restore the filter and close the filter cap.

NOTE:

- Please be careful not to lose the rubber seals set inside and outside of filter cap.
- When installing the filter cap, make sure that the filter is properly set in the filter case and close the filter cap while holding the case vertically. Self-priming will not work or water leakage will be occurred if the filter is not set properly.
- The clogging of the filter will cause the decrease of the discharge pressure.

Cleaning of machine vents

The machine should be kept clean so as to let cooling air pass freely through air vents.

Storing the Unit

- The hoses, nozzles, and spray gun may be stored on the main unit as shown in Figure (30).

Storage

Pump, hose and accessories should always be emptied of water prior to storing as follows:

1. Long periods of nonuse: If the machine is going to be stored for longer periods of time (i.e. over three months) in a room where frost could develop, it is recommended that the machine be filled with an antifreeze solution (similar to the antifreeze solutions used for vehicles).
2. When the device is not used for an extended period of time, lime deposits begin to form in the motor pump, which in turn can lead to starting difficulties.

NEVER START UP A FROZEN MACHINE.

Frost damages are not covered by the guarantee!

Environmental protection



Recycle unwanted materials instead of disposing of them as waste. All tools, hoses and packaging should be sorted, taken to the local recycling centre and disposed of in an environmentally safe way.

Troubleshooting

Fault	Cause	Remedy
The machine does not run when the ON/OFF switch and spray gun lever are pressed.	The plug is damaged. There is insufficient voltage. The pump is locked. The thermal relay has triggered.	Check the plug and fuses to see if they are okay. Manually turn over the motor. Let the motor cool down.
The machine runs, however only weak pressure is generated.	The intake filter is clogged. Air is being drawn in at the connectors. The inlet and outlet valves are clogged or worn. The diameter of the nozzle hole is too large.	Clean the filter. Check the intake connection fitting and the hose connectors. Clean or replace. Check and replace.
The operating pressure is irregular.	Air is being drawn in. The valves are clogged and worn. The seals are worn.	Check the intake connectors. Clean and replace. Check and replace.
The machine suddenly stops.	The thermal relay has triggered due to overheating.	Check the voltage. Turn off the switch and let the motor cool down for a few minutes.
Water drop from connect pars.	The seals are worn.	Check and replace (professional repair shop)
There is a loss of pressure.	The nozzle is worn. The valves are dirty or clogged. The valve seals are worn. The seals are worn. The filter is clogged.	Change the nozzle. Check, clean, replace. Check and /or replace. Check and /or replace. Check and /or clean.
There is excess noise.	Air is being drawn in. The valves are worn, dirty or clogged. The bearings are worn. The water temperature is too high. The filter is dirty.	Check intake lines. Check, clean, replace. Check and /or replace. Lower the temperature to below 40°C. Check and /or replace.
Expelled water is mixed with oil.	The sealing rings (water + oil) are worn.	Check and /or replace.
Water leaks from the pump head.	The seals are worn. The O-ring of the seal set is worn.	Replace the seal. Replace the O-ring.
When the switch is pressed, the motor hums but does not start.	The mains voltage is lower than that specified. The pump is blocked or frozen. The extension cable is not appropriate. (cross section too small, cable too long)	Check to see that the extension cable is appropriate. Replace the exchange cord to an appropriate one.

Discarding the machine

Carry out the following safety measures immediately, if you are no longer going to use the machine:

- Pull out the plug and make the machine inoperable.
- Store the machine in an area that cannot be reached by children.
- Do not use any parts from the used machine as replacement parts.
- Disassemble the machine and discard the individual parts in accordance with the regulation neforced in your area.

SAVE THESE INSTRUCTIONS

KYOCERA Industrial Tools Corporation
2-2-54 Matsuhama-cho, Fukuyama-shi,
Hiroshima-ken, 720-0802 Japan